

# Biologic™ ReeCharge

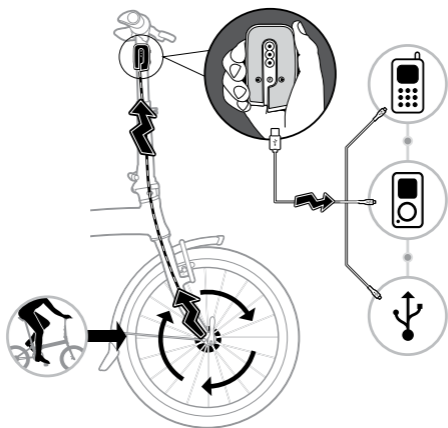

## Owner's Manual

# Biologic™ ReeCharge



## CAUTION

### **Carrying the ReeCharge**

The ReeCharge contains delicate components. Do not bend, drop, or crush ReeCharge units.

### **Using connector ports**

Never force a connector into a port. Make sure that the connector matches the port and that you have positioned the connector correctly in relation to the port.

### **Keep the ReeCharge within acceptable temperatures**

Battery life might be affected by extreme temperature conditions. Always keep the ReeCharge between -20°C and 45°C. Avoid fire and high heat conditions.

### **Charging the ReeCharge**

Connect the ReeCharge to the bicycle dynamo hub using only a compatible cable with a power regulator. **Do not connect the ReeCharge with a regular wire to the dynamo hub.**

Standard 6V/ 2.4W or 6V/ 3.0W dynamo hubs can be connected via a power regulator cable to the ReeCharge.

The ReeCharge can be charged using a USB port.

When charging the ReeCharge with alternative power sources, **use only 5V DC output charging devices rated at less than 1A**. The ReeCharge and its adaptor may become warm during normal use. Always allow adequate ventilation around the ReeCharge.

**Please read the safety instructions** for all products and accessories before using them with the ReeCharge. MINIWIZ and Dahon are not responsible for the operation of third party accessories or their compliance with safety and regulatory standards.

### **Avoid submerging in water**

Do not submerge the ReeCharge in water. The ReeCharge is weatherproof, but not water resistant. Do not attempt to dry the ReeCharge device with an external heat source such as a hair dryer, radiator, or oven.

### **Charge safely while cycling**

Do not attempt to operate the buttons or connectors of the ReeCharge while cycling. Do not charge the ReeCharge when using a light that is connected to the same dynamo hub. When using the light and charging the ReeCharge simultaneously, the power from the dynamo hub is split between the two devices, which lowers the brightness of the light, which can compromise safety at night.

**Choking hazard**

The ReeCharge contains small parts, which may present a choking hazard to small children. Keep the ReeCharge and its accessories away from small children.

**Do not throw in trash**

The built-in lithium-ion battery can be recycled. Please dispose of the battery at the nearest recycling location in your area.

**Notice**

Dahon and MINIWIZ are not responsible for any failures the ReeCharge might cause to devices charged with the unit.

# FEATURES

1. The ReeCharge enables the charging of a mobile device from a bicycle dynamo hub.
3. The ReeCharge can be securely fastened onto a bicycle handlepost, stem or handlebar, so that it **can be charged while cycling**.
4. Electronic devices can be charged through the ReeCharge while cycling or they can be charged from the charged battery of the ReeCharge when not cycling.
5. The ReeCharge has **universal adaptors** and a **USB cable**, which allow charging of a large selection of different devices, including, but not limited to iPhone®, iPod®, Nokia®, Sony®, Samsung®, BlackBerry®, Mini-USB port, PDA, GPS, MP3 player, and other 5V handheld devices.
6. An **included wall charger** allows the ReeCharge to be used as a universal charger for most 5V handheld wireless devices.
7. The ReeCharge can be used as an **extra power source** for a wide variety of electronic devices. Its built-in 1600 mAh lithium ion polymer rechargeable battery gives you extra battery capacity when you need it.
8. No additional software is required.

## ReeCharge Overview

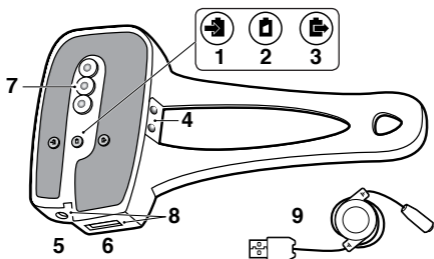

1. Charge In Button
2. Battery Status Button
3. Charge Out Button
4. Charging Indicator Lights
5. Charging Socket
6. Charge Out USB Socket
7. Battery Status/ Safety Light
8. Self Opening Sealing Flaps
9. USB charging cable (included).

### 1. Charge In Button

- Push this button to start or stop charging the ReeCharge.
- The ReeCharge is being charged when the green light on the side of the device is lit.
- **NOTE:** The green light on the side is on only when the ReeCharge is receiving enough electricity to charge its internal battery.

### 2. Battery Status Button

- Push this button to turn the Battery Status/ Safety Light on or off.

### **3. Charge Out Button**

- Push this button to start or stop charging external devices through the ReeCharge.
- The ReeCharge is charging any attached device when the red light on the side of the ReeCharge is lit.
- **NOTE:** When the red light on the side of the ReeCharge is lit the ReeCharge is releasing its charge no matter if a device is connected or not.
- Make sure that the red light is off if you do not intend to charge other devices or do not want the ReeCharge to discard completely.

### **4. Charging Indicator Lights**

- Green light On indicates that ReeCharge is charging. Notice the light is on only when the ReeCharge is receiving enough electricity to charge its internal battery.
- Red light On indicates that ReeCharge is ready to charge external devices. **NOTE:** When the red light is on the ReeCharge is releasing its charge no matter if a device is connected or not.

### **5. Charging Socket**

- The cable for charging the ReeCharge is inserted here.

### **6. Charge Out USB Socket**

- USB cables for charging other devices from the ReeCharge are connected here.

## 7. Battery Status/ Safety Light

- Shows the ReeCharger's battery status
  - 3 lights lit: Fully charged (over 80%)
  - 2 lights lit: Half full
  - 1 light lit: Almost empty
  - No lights lit: Empty
- The lights also serve as a safety light at night.

## 8. Self Opening Sealing Flaps

- The ReeCharge has water sealing flaps in front of the cable connecting ports. These flaps open inwards when pushing the cable into the socket.
- Just push the plugs into the ports and the flaps will open.

## 9. Retractable USB charging cable

- This cable connects other devices to ReeCharge and also ReeCharge to PC.

**NOTE:** The USB plug has to be upside down when inserting into the ReeCharge.

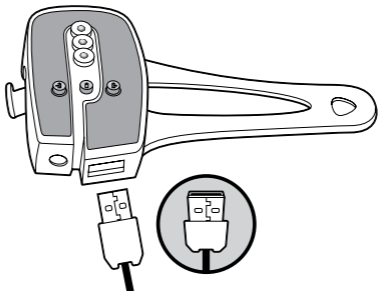



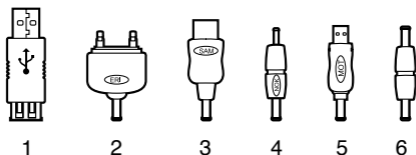

### **Included set of connector adapters**

1. Apple Connector
  2. Sony Ericsson
  3. Samsung
  4. Later-model Nokia
  5. Motorola/ Mini USB
  6. USB Charging Cable Connector Adapter
- NOTE: Though this connector will fit early model Nokia phones, it will NOT allow the ReeCharge to charge them.

**NOTE:** To charge Apple products with the ReeCharge, you need to use the Apple Connecting with the USB cable that was included with the Apple device.

**NOTE:** The USB charging cable connector adapter, which allows the ReeCharge to be charged from the USB port of a PC, fits early-model Nokia phones but it will NOT charge such phones. Newer Nokia phones with a small charger plug can be charged with the ReeCharge.

# Charging the ReeCharge

**The ReeCharge can be charged in three different ways:**

- A. From a bicycle dynamo hub
- B. From a PC / laptop USB 2.0 port
- C. From a conventional 100~240V AC wall adaptor (Not included with OEM package. Only included in aftermarket package)

## **A. Charging from a bicycle dynamo hub**

1. Fasten the ReeCharge to the bike (see Mounting the ReeCharge).
2. Connect the ReeCharge to the dynamo hub with the power regulator cable (see Connecting the ReeCharge to the Dynamo Hub).
3. Press the Charge In Button to enable charging.
4. The ReeCharge is charging when the green light on the side of the ReeCharge is lit.
  - **NOTE:** The green light is only on when the wheel rotates fast enough to provide the ReeCharge with a current for charging.
  - **NOTE:** To cycle without the slight added rolling resistance coming from the dynamo hub charging the ReeCharge, turn off the charging function by pressing the Charge In Button. Charging is disabled when the green light on the side of the ReeCharge does not light up when the bike is in motion.

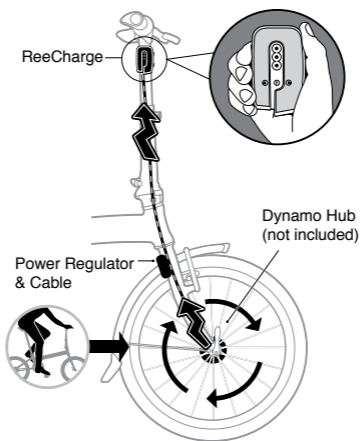

To starting charging the ReeCharge, **press the Charge In Button**. This enables the device to be charged.

**NOTE:** If charging is not enabled with the Charge In Button the ReeCharge will not charge, even when the bike is in motion.



The ReeCharge itself is charging when the green light on the side of the device is lit.

**NOTE:** The green light is only lit when the wheel rotates fast enough to charge the ReeCharge.

## B. Charging from a PC / laptop USB 2.0 port

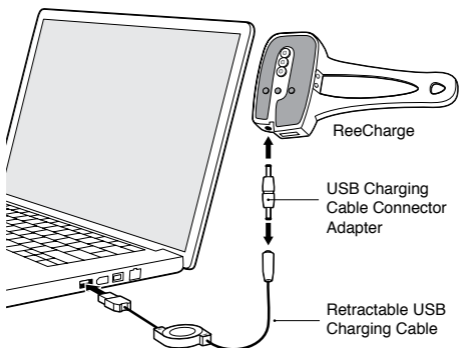

1. Fasten the retractable USB charging cable to the PC's USB port.
2. Fasten the other end of the USB cable to the USB charging cable connector adapter.
3. Connect the adapter to the **Charging Socket** of the ReeCharge.
4. Press the **Charge In Button** to enable charging.



5. The ReeCharge is charging when the green light on the side of the ReeCharge is lit.



**NOTE:** If the green light on the side is not lit the ReeCharge is not charging even if the cable is connected to the PC's USB port.

**C. Charging from a conventional 100~240V AC power converter (NOTE: AC power converter kit available only in after market package)**

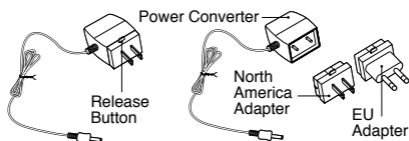
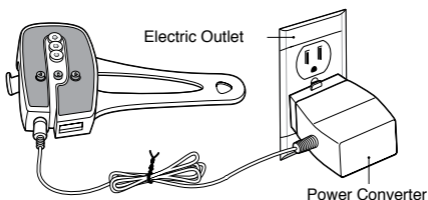

1. Select the wall plug adapter to match the available electric network. The ReeCharge is equipped with adapters for EU and North America.
2. Connect the proper wall plug adapter to the power converter. To change the wall plug adapter, press the button on the side of the power converter and release the adapter from the body of the unit.
3. Connect the power converter cable to the **Charging Socket** of the ReeCharge.
4. Plug the power converter into the electric outlet.

5. Press the **Charge In Button** to enable charging.



6. The ReeCharge is charging when the green light on the side of the ReeCharge is lit.



**NOTE:** If the green light on the side is not lit the ReeCharge is not charging even if the cable is connected to the electric outlet.

## **Charging external devices with the ReeCharge**

The ReeCharge's internal battery needs to have some charge before it can charge other devices. Other devices can be charged at the same time when the ReeCharge is charging or they can be charged after the battery of the ReeCharge is first charged.

Depending on the device being charged there are two different situations when charging with the ReeCharge.

- **Situation 1:** Charging most electronic devices with the ReeCharge.
- **Situation 2:** Charging electronic devices from Apple with the ReeCharge.

## Situation 1: Charging most external devices with the ReeCharge

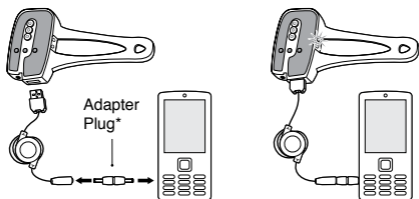

*\*NOTE: Different adapter plugs are used with different devices.*

1. Connect the retractable USB charging cable to the **Charge Out USB** socket of the ReeCharge.
2. Connect the other end of the retractable USB charging cable to the appropriate adapter plug. **NOTE:** Different adapters allow the charging of different devices. For a list of devices that can be charged, please see: USB Adaptor Support List.
3. Press the **Charge Out Button** on the ReeCharge to begin charging the device. The red light on the side of the ReeCharge will light up.



4. The external device is now being charged.

**NOTE:** When the red light on the side of the ReeCharge is lit, the ReeCharge is discharging even if a device is not connected to it. To save the energy stored in the ReeCharge, press the Charge Out Button to turn off the charging of external devices.



## Situation 2: Charging electronic devices from Apple with the ReeCharge

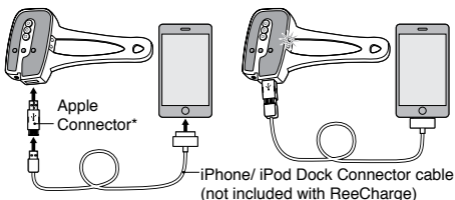

*\* The ReeCharge cannot charge Apple products without the use of this connector.*

1. Connect the Apple Connector to the Charge Out USB socket of the ReeCharge.
2. Connect the Dock Connector to USB Cable (not included) to the Apple Connector.
3. Connect the other end of the USB cable to the iPhone/ iPod.
4. Press the **Charge Out Button** on the ReeCharge to begin charging the device. The red light on the side of the ReeCharge will light up.



5. The iPhone/ iPod is now being charged.

**NOTE:** When the red light on the side of the ReeCharge is lit, the ReeCharge is discharging even if a device is not connected to it. To save the energy stored in the ReeCharge, press the Charge Out Button to turn off the charging of external devices.

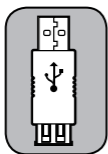

**NOTE:** The charging of Apple products requires the use of the Apple Connector. Without this connector, the device will not charge. The ReeCharge cable cannot be used to charge Apple products.



**NOTE:** When the red light on the side of the ReeCharge is lit, the ReeCharge is discharging even if a device is not connected to it.

## Mounting the ReeCharge

If the ReeCharge came with your Dahon bike, it is already completely mounted and installed on your bike.

Please refer to the following instructions if you bought the ReeCharge separately or if for some reason the ReeCharge was removed from your bike and you want to remount it.

**WARNING:** If you are in any way unsure of how to perform this assembly, take your bike to a qualified bicycle technician for professional assembly.

### Attach the ReeCharge to the Handlepost

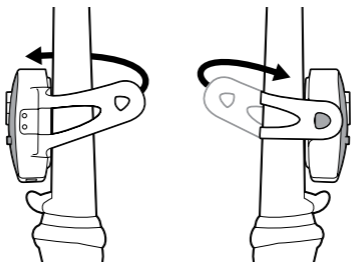

## Connecting the ReeCharge to the dynamo hub together with a front light

The ReeCharge can be connected to a dynamo hub that already has a light unit connected to it. The ReeCharge can also be connected to dynamo hub without the light cable.

**NOTE:** When using the light and charging the ReeCharge simultaneously, the power from the dynamo hub is split between the two devices, which might lower the brightness of the light, which can compromise safety in darkness. Using the light simultaneously while charging the ReeCharge also makes the charging of the ReeCharge slower.



*The light cable connector is connected to the dynamo hub.*

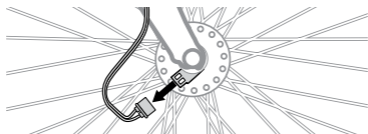

1. Unplug the light cable connector.

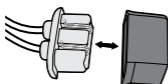

2. Remove the cover of the cable connector.

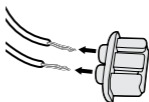

3. Pull out the wires from the grey wire holder.



4. Twist the ends of the ReeCharge cable with that of the light cable.

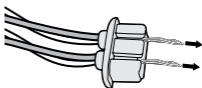

5. Put the connected light and ReeCharge wires back into the grey wire holder.

6. Fix the wires into the grey wire holder by bending them around the holder.

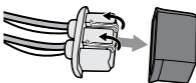

7. Put the black cover back onto the grey wire holder.

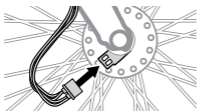

8. Attach the cable connector to the dynamo hub.

**WARNING:** Please make sure the two groups of wires are not in contact with each other. This will short-circuit the electronics and might cause damage to the light and the ReeCharge.

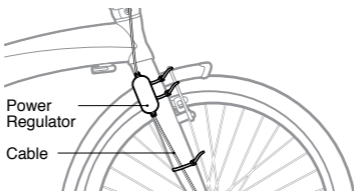

9. Fasten the power regulator with zipties to the front fork. Connect the cable to the fork so that it does not go between the spokes when cycling.

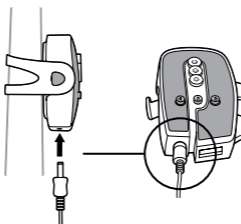

10. Connect the free end of the ReeCharge cable to the Charge In Socket of the ReeCharge.

## Fastening external devices to the bicycle handlebar

A wide selection of different devices can be mounted on the bike handlebar with a silicon fastening strap (Not included with the bicycle. Only available in aftermarket packaging).

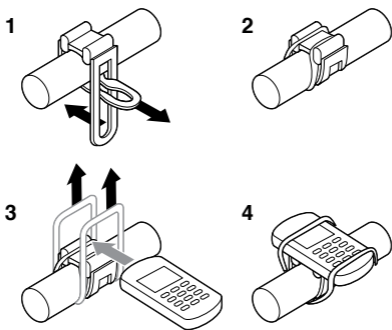

**NOTE:** Cycling can cause strong shaking of the handlebar, which might make any attached device fall out of the elastic fastening strap causing serious damaged to the device. Dahon and MINIWIZ are not liable for any damages caused by the failure of this fastening strap.

## Technical Specifications

### Size:

- Height: 85 mm/ 3.3 inches
- Width: 60 mm/ 2.4 inches
- Depth: 30 mm/ 1.2 inches
- Weight: 3 ounces (~90 g)

**Battery:** Built-in 1600mAh lithium-ion polymer rechargeable battery

**Input current:** less than 1A or 1000mA and 5V max

**Minimum operating speed:** 15 km/h (based on a 20" wheel with 6V/ 2.4W dynamo hub)

### Type of power inputs:

- Bicycle dynamo hub (input voltage and current varies with different cycling speed and battery loading conditions)
- PC/ laptop USB 2.0 outlet
- Conventional 100~240V AC adaptor
- NOTE: Due to safety concerns for the lithium-ion battery, charge-in voltage and current are limited.

### Universal power output:

- USB 2.0 output at 5V adaptive 200mA ~ 850mA depending on devices
- Common 5V digital devices include mobile phone, MP3 players, iPhones/ iPods3, PDAs
- (Mobile device recharge time via USB is about 1-2 hours depending on device)



## **USB adapter support list\***

*\* Valid as of September 1, 2009. For models not listed below, consult with your device manufacturer.*

### **Compatible with:**

Apple<sup>3</sup> iPhone 2G/3G/3Gs, iPod touch, iPod nano, iPod 5th generation, iPod classic, iPod video

Most new Nokia<sup>4</sup>, Sony Ericsson<sup>5</sup>, Motorola<sup>7</sup>, BlackBerry<sup>8</sup>, iRiver<sup>10</sup>, Garmin<sup>9</sup> GPS, TomTom<sup>11</sup> and new Samsung<sup>6</sup> phones and devices

Some Digital Cameras and many other devices that can be charged via a USB Port.

### **Referenced Trademarks**

1. **BioLogic™** is a registered trademark of Dahon in the U.S.A. or other countries.
2. **ReeCharge** is a trademark of Dahon in the U.S.A. or other countries.
3. **iPod®** and **iPhone®** are registered trademarks of Apple Inc. in the U.S.A. or other countries.
4. **Nokia** is a registered trademark of Nokia Corporation in the U.S.A. or other countries.
5. **Sony Ericsson** is a registered trademark of Sony Ericsson Mobile Com. AB in the U.S.A. or other countries.
6. **Samsung** is a registered trademark of SAMSUNG Corporation in the U.S.A. or other countries.

7. **Motorola** is a registered trademark of Motorola, Inc in the U.S.A. or other countries..
8. **BlackBerry®** is a registered trademark of Research In Motion in Canada or other countries.
9. **Garmin®** is a registered trademark of Garmin Ltd. in the U.S.A. or other countries.
10. **iriver** is a registered trademark of ReignCom Co., Ltd. in the U.S.A. or other countries.
11. **TomTom®** is registered Trademark of TomTom International.

\* Brand and product names mentioned are trademarks of their respective companies.

\* All specifications are subject to change without notice. Please check with your supplier for exact offers.

\* Products may not be available in all markets

.

\* Product colors and accessories are subject to change without notice.

\* MINIWIZ and Dahon accept no responsibility for damages of other devices charged by the BioLogic™ ReeCharge.

**Dahon California INC.**

833 Meridian Street  
Duarte CA 91010  
1-800-442-3511

**Dahon TW**

8F-8, #6, Lane 609, Chung Hsin RD., Sec 5  
San Chung, Taipei Hsien ROC 241, Taiwan  
+886-2-2999-5623

**<http://www.thinkbiologic.com/reecharge>**